

Exhibit A

Important notes:

- 1. All references to NFPA 70 NEC shall be changed from the 2014 edition to the 2017 edition.*
- 2. All references to Zoning and building line shall be referred to the Zoning chapter(s) of the Code of Ordinances of the City of Rock Island.*
- 3. Adoption of the IBC includes adoption of the IFGC, IMC, IPC, IPMC, IFC, and IECC. The IRC, IEBC, ISPSC, and NEC are individually adopted.*
- 4. Amendments to the 2015 International Fire Code (IFC) are found elsewhere, submitted by the RIFD.*

Enclosure 1 – Amendments to 2015 International Building Code (IBC)

Enclosure 2 – Amendments to 2015 International Residential Code (IRC)

Enclosure 3 – Amendments to 2015 International Existing Building Code (IEBC)

Enclosure 4 – Amendments to 2015 International Energy Conservation Code (IECC)

Enclosure 5 – Amendments to 2015 International Property Maintenance Code (IPMC)

Enclosure 6 – Amendments to 2015 International Mechanical Code (IMC)

Enclosure 7 – Amendments to 2015 International Fuel Gas Code (IFGC)

Enclosure 8 – Amendments to International Plumbing Code (IPC) and Section 4.3 of Code of Ordinances

Enclosure 9 – Amendments to International Swimming Pool and Spa Code (ISPSC)

Enclosure 10 – Amendments to the National Fire Protection Association 2017 National Electrical Code (NEC)

Enclosure 1 – Amendments to 2015 International Building Code (IBC)

101.1 Title. Replace *[NAME OF JURISDICTION]* with “City of Rock Island”

101.2 Scope Add “1.” To exception and add exception: “2. Existing buildings undergoing repair, alternations, additions, or change of occupancy shall be permitted to comply with the *International Existing Building Code*.”

101.4.3 PLUMBING: The most recent edition of the *Illinois Plumbing Code* shall apply to the installation, alteration, repair, relocation, addition, replacement, and maintenance of plumbing systems regulated by the *Illinois Plumbing Code*. The *International Plumbing Code* and the *International Fuel Gas Code* shall apply to any and all plumbing and piping systems not regulated by the *Illinois Plumbing Code*. In addition, any structure in which a building drain is installed shall have at least one (1) vent stack carried through the roof and increased to a minimum size of Four Inches (4”) at a point one foot (1’) below the roof line.

103 Department of Building Safety – Delete; reserve section.

104 Duties and Powers of the Building Official Delete; reserve section.

109 Fees. Delete; reserve section.

113 Board of Appeals Delete; reserve section.

1608.2 Ground Snow Loads Replace all the text with:

“The ground snow loads to be used in determining the design snow loads for roofs shall be not less than $p_g = 30$ psf. ASCE 7 calculations for additional drift and surcharge loads shall use not less than $p_g = 25$ psf.”

1612.3 Establishment of flood hazard areas. Replace *[INSERT NAME OF JURISDICTION]* with “City of Rock Island” and replace *[INSERT DATE OF ISSUANCE]* with “5 April 2010”

Adopt the following Appendices:

C Group U – Agricultural Buildings

E SUPPLEMENTARY ACCESSIBILITY REQUIREMENTS

F RODENT PROOFING

G FLOOD-RESISTANT CONSTRUCTION

H SIGNS

I PATIO COVERS

K ADMINISTRATIVE PROVISIONS

Enclosure 2 – Amendments to 2015 International Residential Code (IRC)

R101.1 Title. Replace [NAME OF JURISDICTION] with “City of Rock Island”

R101.2 Scope, Add “1.” to published exception. Add exception: “2. The most recent edition of the *Illinois Plumbing Code* shall apply to the installation, alteration, repair, relocation, addition, replacement, and maintenance of plumbing systems as stipulated by the *Illinois Plumbing Code*. The provisions of the *International Residential Code* shall apply to all plumbing and piping systems not covered by the *Illinois Plumbing Code*.” In addition, ANY structure in which a building drain is installed shall have at least one (1) vent stack carried through the roof and increased to a minimum size of Four Inches (4”) at a point one foot (1’) below the roof line.

R103 Department of Building Safety – Delete; reserve section.

R104 Duties and Powers of the Building Official Delete; reserve section.

R108 Fees Delete; reserve section.

R109 Board of Appeals Delete; reserve section.

Table R301.2(1) Climatic and Geographic Criteria

Ground Snow Load	Wind Design			Seismic Design Category ^f	Subject to Damage From		
	Speed ^d (mph)	Topographic Effects ^k	Wind-borne Debris Zone ^m		Weathering ^a	Frost line depth ^b	Termite ^c
p _s = 30 psf, except that calculations for additional drift loads shall use a ground snow load p _g = 25 psf	115	YES	NO	A	SEVERE	42”	Moderate to Heavy

Winter Design Temp ^e	Ice Barrier Underlayment Required ^h	Flood Hazards ^g	Air Freezing Index ⁱ	Mean Annual Temp ^j
-4° F	YES	Initial NFIP 7/10/1971 Community# 175171 Current FIRM 4/5/2010	2000	50.5° F

R315.3 Location

Change: "...in the immediate vicinity of the bedrooms." to "within 15 feet of the door to the sleeping area in dwelling units within which fuel-fired appliances are installed and in dwelling units that have an attached garage."

R322 Flood-Resistant Construction. Delete text in its entirety and add: See The City of Rock Island Code of Ordinances Chapter 11 Planning and Redevelopment, Article IV Flood Hazards.

R403 footings: Tables R403.1(1), (2), and (3), are optional and inserted table R403.1(4), below, may be used instead:

Table R403.1(4) Simplified Minimum Width and Thickness for Concrete Footings

# of floors	Wall Thickness Concrete	Wall Thickness Masonry	Width of footing	Thickness of footing	Depth of footing
1	8"	8"	16"	8"	42"
2	8"	8"	16"	8"	42"
3	10"	12"	20"	12"	42"

Foundations may support a roof in addition to the stipulated number of floors. Foundations supporting roofs only shall be as required for supporting one (1) floor. Footings shall be continuous and contain a minimum of two (2) ½" reinforcement bars and have a minimum compressive strength of 3,000 psi at 28 days.

Add new section **R403.1.1.1.1 Footing requirements for uncovered decks.** Deck footings NOT supporting a roof or over head structure shall be a minimum 12 inches in diameter and 42 inches below finished grade.

Add new section **R403.1.1.1.2 Footing requirements for covered decks and room additions.** All elevated and covered decks, screened porches; three season rooms, four season rooms, and room additions, shall comply with one of the following:

1. Pier footings designed by an Illinois licensed design professional and submitted with stamped and signed plans.
2. 12 inch wide trench footing 42 inches in depth with at least two (2) ½" reinforcing bars horizontally, one top and one bottom with a minimum of 3" concrete coverage.
3. Spread footings 42 inches in depth sized with reinforcement with a minimum 8 inch masonry wall or concrete foundation wall as per **Table 403.1(4).**

Add to R404.1.3.2 Reinforcement for foundation walls.

"Exceptions:

1. For concrete walls up to 8' (eight feet) in height, the design requirements of **Figure 404.1.3.1 (b)** may be met in lieu of engineered drawings.
2. For Concrete walls over 8' (eight feet) to 9' (nine feet) in height, the design requirements of **Figure 404.1.3.1 (a)** may be met in lieu of engineered drawings.

All other concrete walls shall be designed in accordance with standard engineering practice and bear the stamp of an Illinois Licensed design professional."

N1101.1 Scope. Delete all text after the text of section **N1101.1 Scope.**

Replace with: "**N1101.2 Compliance.** Compliance shall be demonstrated by meeting the requirements of the Illinois Energy Conservation Code."

P2603.5.1 Sewer Depth. Replace *[NUMBER]* with “42” in both locations.

Part VIII Electrical, Chapters 34- 43 Chapter 34 General Requirements.

Replace 2014 National Electrical Code ® and NFPA 70®-2014 with “2017 National Electrical Code ® and NFPA 70®-2017” throughout.

(Add) Where the 2017 National Electric Code NFPA 70 as referenced is amended by this Resolution, such amendments are to be interpreted as a minimum requirement for this Part. Requirements for registration with the jurisdiction, permits, fees and violations/penalties of this 2015 International Residential Code hereby apply to the 2017 National Electric Code NFPA 70.

E3406.3 Minimum Size of Conductors.

(Change) 14 AWG Copper to 12 AWG Copper.

(Change) 12 AWG Aluminum to 10 AWG Aluminum.

(Add) In ALL instances, where this code or the NFPA70 references 14 AWG Copper, 12 AWG Copper shall apply. In ALL instances, where this code or the NFPA70 references 12 AWG Aluminum to 10 AWG Aluminum shall apply.

Appendices: **Adopt as noted:**

A- Sizing and Capacities of Gas Piping

B- Sizing of venting systems serving appliances equipped with draft hoods, Category 1 appliances, and

appliances listed for type B vents

C- Exit terminals of mechanical draft and direct-vent venting systems

D-Recommended Procedure for inspection of an existing appliance installation

E-Manufactured housing used as a dwelling

F-Passive Radon Gas Control with the following amendments:

AF102 Definitions.

Vent Pipe – delete “...ABS or...” and replace with “...schedule 40...”

AF103.2.2 –Delete second sentence: (“Sumps used as the suction point in a sub slab depressurization system shall have a lid designed to accommodate the vent pipe.”)

AF103.4.3 – In the third sentence delete “the roof” and insert “above the highest eave of the house”.

AF103.5 Drain Tile and sump used for depressurization – Replace all text with: “As an alternative to inserting a vent pipe into a “T” fitting, a vent pipe shall be permitted to be inserted directly into an interior perimeter drain tile loop.” Delete all after this point.

AF103.6 – Replace the last sentence with: “ Vent pipes shall connect to a single vent that terminates at least 12” above the highest eave of the house or each individual vent pipe shall terminate separately at least 12” above the highest eave of the house.”

H-Patio Covers

J- Existing Buildings and Structures

K-Sound transmission

M-Home Day care- R-3 Occupancy



Building Guide

ILLOWA Chapter of ICC

FOUNDATION WALL REINFORCEMENT

All Foundation Walls over 8FT to 9FT in height
with up to 8' Unbalanced load



IRC Figure 404.1.3.1 (a)

Note: Wall must extend 6" above finished Grade,
Walls over 9 ft or with more than 8 ft of unbalanced load require stamped engineered drawings.

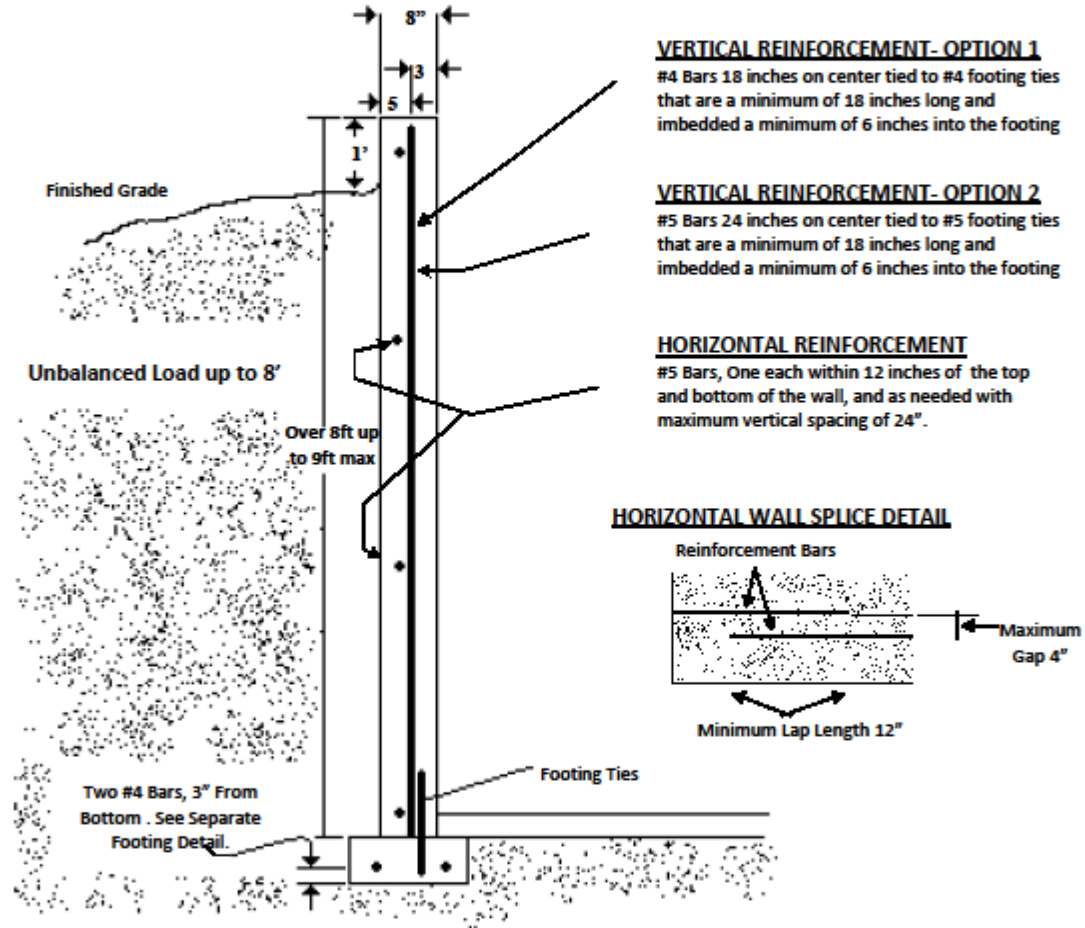

VERTICAL REINFORCEMENT- OPTION 1

#4 Bars 18 inches on center tied to #4 footing ties that are a minimum of 18 inches long and imbedded a minimum of 6 inches into the footing

VERTICAL REINFORCEMENT- OPTION 2

#5 Bars 24 inches on center tied to #5 footing ties that are a minimum of 18 inches long and imbedded a minimum of 6 inches into the footing

HORIZONTAL REINFORCEMENT

#5 Bars, One each within 12 inches of the top and bottom of the wall, and as needed with maximum vertical spacing of 24".

HORIZONTAL WALL SPLICE DETAIL

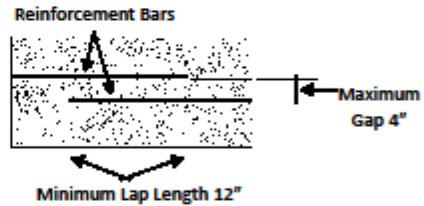

DESIGN LOADS: Soil Weight: 120 PCF
Lateral Liquid Equivalent Soil Pressure: 50PCF
Soil Level One Foot Below Top of Wall



Building Guide

ILLOWA Chapter of ICC

FOUNDATION WALL REINFORCEMENT

All Foundation Walls up to 8 FT in height
with up to 7 ft Unbalanced Load



IRC Figure 404.1.3.1 (b)

Note: Wall must extend 6" above finished Grade

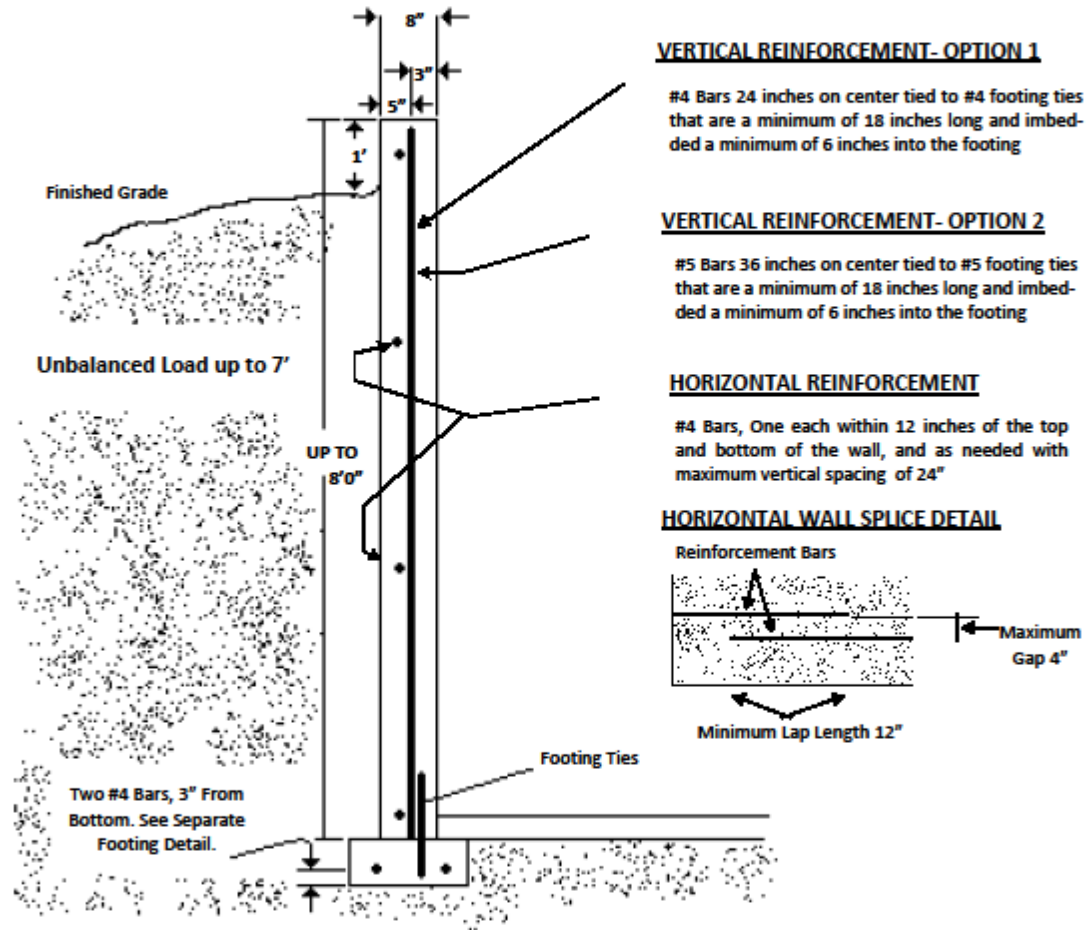

DESIGN LOADS: Soil Weight: 120 PCF
Lateral Liquid Equivalent Soil Pressure: 50PCF
Soil Level One Foot Below Top of Wall

Enclosure 3 – Amendments to 2015 International Existing Building Code (IEBC)

101.1 Title. Replace *[NAME OF JURISDICTION]* with “City of Rock Island”

103 Department of Building Safety - Delete; reserve section.

104 Duties and Powers of Code Official - Delete; reserve section.

108 Fees Delete; reserve section.

112 Board of Appeals Delete; reserve section.

1401.2 Applicability. Replace *[DATE TO BE INSERTED... ... WITHIN THE JURISDICTION]* with “7 December 2011”

Enclosure 4 – Amendments to 2015 International Energy Conservation Code (IECC)

The current edition of the Illinois Energy Conservation Code shall be enforced.

Sections C107, C109, R107, R109 Delete; reserve sections.

Enclosure 5 – Amendments to 2015 International Property Maintenance Code (IPMC)

101.1 Title. Replace *[NAME OF JURISDICTION]* with “City of Rock Island”

111 Means of Appeal Delete; reserve section.

302.4 Weeds. Insert (10’)

304.14 Insect Screens Insert “April 1st to November 1st”

602.3 Heat supply Insert “October 1st to May 15th”

602.4 Occupiable work spaces Insert “October 1st to May 15th”

ADD NEW TEXT AS FOLLOWS:

603.1.1 Property owners are required to have annual carbon monoxide tests of furnaces performed for all fuel-burning furnaces that are 10 years old or older and for all fuel-burning furnaces that have been inoperative for one year or longer. Tests must be performed by a properly certified and registered mechanical contractor. Owners shall immediately notify Inspection Division of failed tests. Owners shall provide a legible certified copy of successful test results to Code official not later than 30 days after the test.

Exception: A carbon monoxide detector installed within 10’ of furnace will meet the intent of the annual carbon monoxide test requirement.

ADD NEW TEXT AS FOLLOWS:

603.1.2: Every dwelling unit shall be equipped with at least one approved carbon monoxide alarm in an operating condition within 15 feet of every room used for sleeping purposes. Carbon monoxide detector/smoke detector alarms may be installed only if the combined unit provides different alarm tones for the carbon monoxide detection and the smoke detection.

Every structure that contains more than one dwelling unit shall contain at least one approved carbon monoxide alarm in operating condition within 15 feet of every room used for sleeping purposes.

The required carbon monoxide detector/alarm is permitted to be solely battery operated in buildings where no construction is taking place, buildings that are not served from a commercial power source and in existing areas of buildings undergoing alterations or repairs that do not result in the removal of interior wall or ceiling finishes exposing the structure, unless there is an attic, crawl space or basement available which could provide access for building wiring without the removal of interior finishes.

Exception: Carbon Monoxide Detectors are not required if:

A residential unit is in a building that does not rely on combustion of fossil fuel for heat or hot water and the building is not connected in any way to a garage and the building is not contiguous to a source of carbon monoxide.

Replace 605.2 Receptacles. Every habitable space in a dwelling shall contain at least two separate and remote receptacle outlets. Every laundry area shall contain at least one grounded-type receptacle or a receptacle with a ground fault circuit interrupter.

Add 605.2.1 Bathrooms in Residential units. Each bathroom in residential units shall have at least one receptacle. Every bathroom receptacle in residential units shall be protected against ground faults by means of a ground fault circuit interrupter or other approved means.

Add 605.2.2 Kitchens in Residential units. Every kitchen countertop receptacle that is within 6 feet of a sink or exposed pipe shall be protected against ground faults by means of a ground fault circuit interrupter or other approved means.

Replace full text of **606.1 General.** with:

606.1 General. Elevators, dumbwaiters and escalators shall be maintained in compliance with and certified in accordance with State of Illinois statutes and regulations.

Enclosure 6 – Amendments to 2015 International Mechanical Code (IMC)

101.1 Title. Replace *[NAME OF JURISDICTION]* with “City of Rock Island”

Sections 103, 104, 109 Delete; reserve sections.

Enclosure 7 – Amendments to 2015 International Fuel Gas Code (IFGC)

101.1 Title. Replace *[NAME OF JURISDICTION]* with “City of Rock Island”

Sections 103, 104, 109 Delete; reserve sections.

608 Vented Wall Furnaces: Delete section, not allowed.

609 Floor Furnaces: Delete section, not allowed.

Appendix A: adopted by this reference.

Enclosure 8 – Amendments to International Plumbing Code (IPC) and Section 4.3 of Code of Ordinances

For the IPC:

101.1 Title. Replace *[NAME OF JURISDICTION]* with “City of Rock Island”

Sections 103, 104, 109 Delete; reserve sections.

305.6.1 Sewer Depth. Replace *[NUMBER]* with “42” in both locations.

For Code of Ordinances section 4.3:

Replace entire section with:

Sec. 4-3. Plumbing Codes Adopted by Reference:

The most recent edition of the Illinois Plumbing Code shall apply to the installation, alteration, repair, relocation, addition, replacement, and maintenance of plumbing systems regulated by the Illinois Plumbing Code. The International Plumbing Code, 2015 Edition, and the International Fuel Gas Code, 2015 Edition, which are freely viewable on line at <http://publicecodes.citation.com/icod/index.htm>, shall apply to any and all plumbing and piping systems not regulated by the Illinois Plumbing Code. In addition, ANY structure in which a building drain is installed shall have at least one (1) vent stack carried through the roof and increased to a minimum size of Four Inches (4”) at a point one foot (1’) below the roof line.

Enclosure 9 – Amendments to International Swimming Pool and Spa Code

101.1 Title. Replace *[NAME OF JURISDICTION]* with “City of Rock Island”

Sections 103, 104, 108 Delete; reserve sections.

Enclosure 10 – Amendments to the National Fire Protection Association 2017 National Electrical Code (NEC) THIS ENCLOSURE IS UNDER REVIEW FOR EDITORIAL ALIGNMENT WITH 2017 NEC PARAGRAPH NUMBERING

220.14 Other Loads – All Occupancies (Add)

(M) Maximum number of outlets per circuit.

Except as otherwise provided, the maximum number of outlets per circuit shall be:

- | | |
|--|----|
| (1) Lighting outlets in dwelling occupancies | 12 |
| (2) General use receptacles – all dwelling occupancies | 10 |
| (3) General use receptacles – all dwelling kitchen countertops | 2 |

Article 230 – Services. (Change)

230.91 Service-Entrance Conductors Inside Structures.

Location of Over current Protection. The service over current device shall be connected by no more than 10 feet of raceway from the meter device, in structures.

334.10 Uses Permitted. (Delete in its entirety and replace with the following)

Section 334.10 Uses Permitted. Type NM and Type NMC cable, minimum size # 12 copper or equivalent shall be permitted to be used in one-family and two family dwellings, and in multi-family dwellings. All service shall be installed in raceway.

Exception: One-family and two-family dwellings not exceeding three stories in height may utilize # 12 NM or NMC cable or larger without raceways.

334.12 Uses Not Permitted (Add)

Type NM and Type NMC cable shall not be used in any commercial or industrial applications.

404.4 Wet Locations (Add)

“In no case shall any outlet, switch or unapproved fixture be installed within the restricted tub or shower zone. The zone is all encompassing and includes the space directly over the tub or shower and extends Three (3) feet from the side and Eight (8) feet above the top of the tub rim shall be considered minimum distance from said tub or shower.